

# NORTH POINT CABINETS®



Thoughtfully Designed, Carefully Crafted



# The NorthPoint Cabinetry Advantage

Made in North America, NorthPoint Cabinetry features a wide array of QuickBuild™ cabinet designs, providing value with a quality, custom look. Cabinets are in-stock, shipping quickly from our strategically located warehouses across the U.S.

- Unique dovetail and pocket screw cabinet construction for sturdy and fast assembly
- Robust replacement parts program
- Free freight on most orders
- Dedicated customer service support



With 3 dedicated warehouses across the country, NorthPoint Cabinetry products typically ships within 48 hours and arrive in 2-3 business days.



For more information, visit [NorthPointCabinetry.com](http://NorthPointCabinetry.com) or scan the QR code.

# Our Collections

## PREMIER Collection

The Premier Collection features elegant upgrades like soft-close doors and drawers.

### Door Styles: Catalina, Maui

- 3/4" Solid Wood Face Frame
- 1/2" Plywood Cabinet Construction
- Premium 100% Water-based Finishes
- Beautiful, finished interior
- 5/8" solid wood dovetail drawer boxes
- 3/4" thick birch veneered plywood shelves
- 5-year Limited Warranty

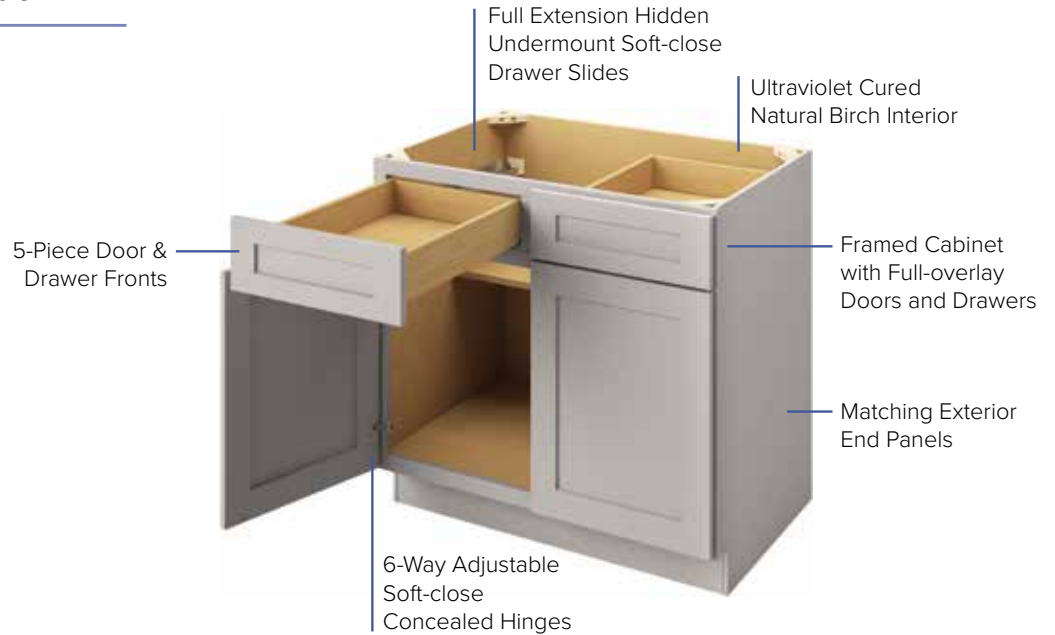

## ESSENTIALS Collection

The Essentials Collection delivers on style at an impressive value.

### Door Style: Hatteras

- 3/4" Solid Wood Face Frame
- 1/2" Plywood Cabinet Construction
- Premium 100% Water-based Finishes
- Beautiful, finished interior
- 5/8" solid wood dovetail drawer boxes
- 3/4" thick birch veneered plywood shelves
- 1-year Limited Warranty

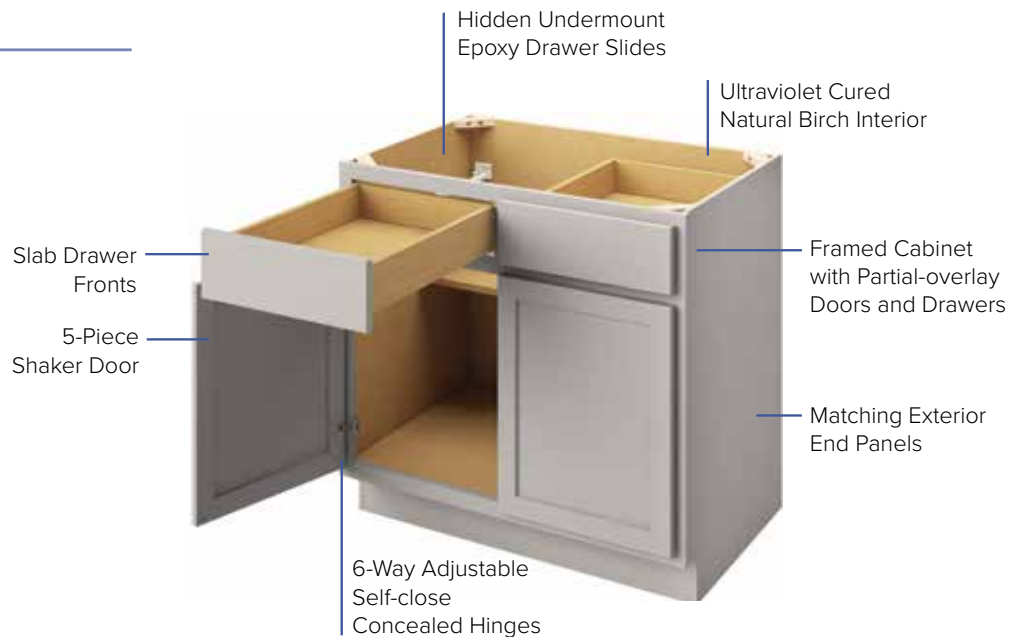

# PREMIER COLLECTION: CATALINA



## CATALINA FINISHES

---



POLAR WHITE  
(PAINTED)



PEBBLE GREY  
(PAINTED)



ESPRESSO  
(STAINED)



SLATE  
(STAINED)

*Coming Summer 2021*





# PREMIER COLLECTION: MAUI



## MAUI FINISHES

---



POLAR WHITE  
(PAINTED)



PEBBLE GREY  
(PAINTED)



ESPRESSO  
(STAINED)



SLATE  
(STAINED)

*Coming Summer 2021*



# ESSENTIALS COLLECTION: HATTERAS



## HATTERAS FINISHES

---



POLAR WHITE  
(PAINTED)



PEBBLE GREY  
(PAINTED)



ESPRESSO  
(STAINED)



Count on consistent, high-quality finishing. Our state-of-the-art manufacturing facility utilizes a multi-step professional finishing process. This meticulous process guarantees that finishes maintain a high degree of color and application accuracy from cabinet to cabinet, which means that every cabinet will look stunning.

Our cabinets and accessories feature water-based ultraviolet (UV) coatings. Water-based UV coatings emit low Volatile Organic Compounds (VOCs) and are environmentally responsible. Ultraviolet finishing uses light instead of heat for curing and the benefits include no environmental pollutants or solvents to evaporate, increased chemical resistance and durability.

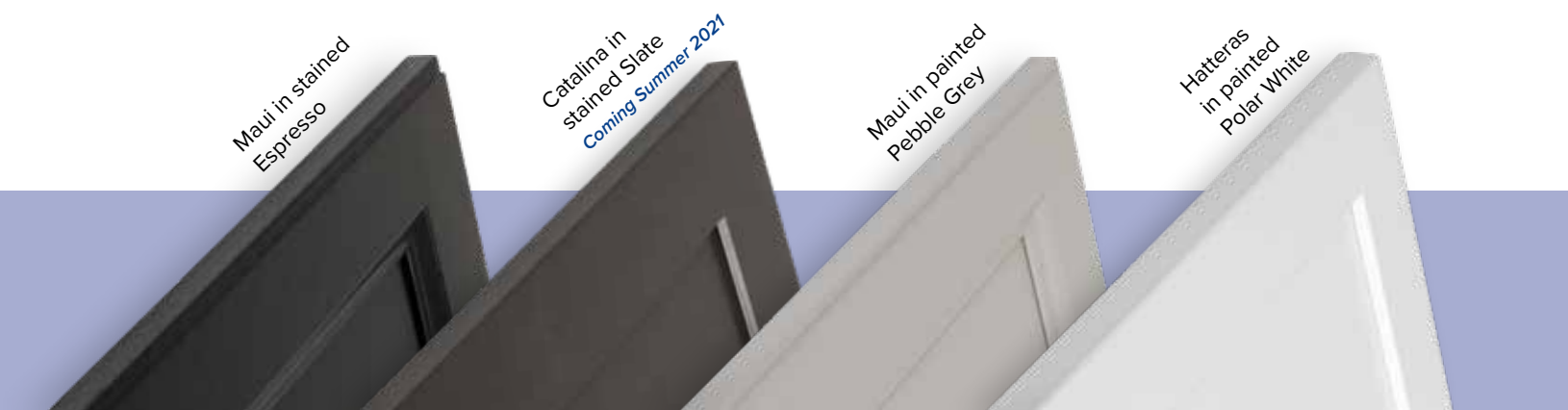

## Premium Multi-Step Finishing Process

1. The finest wood components are sanded with precision
2. A balanced base coat is applied to ensure a consistent, quality finish
3. First stage ultraviolet (UV) curing process occurs
4. The wood is finely sanded and vacuumed
5. A tinted primer is applied as a foundation for our superior finish
6. Second stage (UV) curing
7. The wood is finely sanded and vacuumed
8. The solid paint layer is evenly applied
9. Third stage (UV) curing
10. The wood is finely sanded and vacuumed
11. First layer of water based clear coat is applied
12. The components go through the dryer to prepare for final processing
13. The wood is finely sanded and vacuumed
14. Second layer of water-based clear coat is applied
15. The components go through the dryer once again
16. Final sanding for a smooth surface and vacuumed for a thorough cleaning
17. A final layer of topcoat is evenly applied
18. Oven cured for catalyzed hardened finish
19. Visual inspection with a color consistency examination performed

*Process for stained products varies slightly from the above steps.*

# Quality Comes First

---

Cabinets should withstand the demands of daily use and maintain their integrity throughout their lifetime. That's why when we designed NorthPoint Cabinetry we paid attention to all the details from start to finish. Each cabinet is just as functional on the inside as it is beautiful on the outside.



## It Starts with Quality Wood

Just as a healthy tree needs strong roots to thrive, so too does a quality cabinet require premium lumber at its core. Our cabinets feature solid wood construction, so the quality of wood is of utmost importance.

## Structural Integrity

Meaningful yet hidden reinforcements, like solid wood corner blocks and strategically placed hidden pocket screws, help reinforce the structural integrity of the cabinet. Take comfort that these well-constructed cabinets will stand the test of time.



## Thoughtful Craftsmanship

Boasting an innovative dovetail and hidden pocket screw construction, these cleverly designed cabinets achieve robust quality and quick, accurate assembly.





## Pretty on the Inside Too

NorthPoint Cabinetry features a clean and beautifully finished birch interior that enhances the cabinet's luxurious, high-quality appeal.

## Premium Drawer Boxes

Dovetail joinery is the hallmark of high-quality drawer boxes. The finished interior of the drawer boxes coupled with the dovetail construction and silky-smooth concealed slides make this drawer box the star of the show.



## Hardworking Hardware

Our cabinets feature discreet compact hinges and concealed undermount slides. The hinges & slides have been 3rd party tested and exceed industry standards. The Premier collection (shown) features full extension slides so that you can easily access and make use of the whole drawer.

## Sturdy Shelves

NorthPoint Cabinetry shelves are constructed from an impressive  $\frac{3}{4}$ " birch veneered plywood, preventing sagging over time under the weight of normal use. Shelf height is adjustable so the homeowner can optimize the storage space.



# Cabinet Lineup

## WALL CABINETS

12" deep except where noted  
 42" high wall cabinets will have 3 shelves  
 \*39" and 42" widths will have a vertical center stile unless otherwise noted

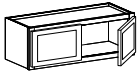

**Double Door**  
 12" Height  
 30", 33", 36"  
 or \*39" Width

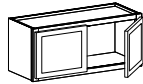

**Double Door**  
 15" Height  
 30", 33", 36"  
 or \*39" Width

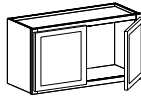

**Double Door**  
 18" Height  
 21", 24", 30", 33", 36"  
 or \*39" Width

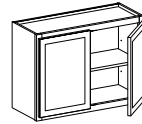

**Double Door**  
 24" Height  
 30", 33", 36" or \*39" Width

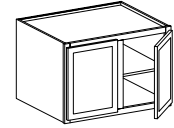

**Deep Double Door**  
 18" or 24" Height • 24" Depth  
 36" or \*39" Width  
 18" Height does not have shelf

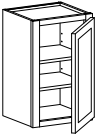

**Single Door**  
 30" Height  
 9", 12", 15", 18" or 21" Width



**Double Door**  
 30" Height  
 24", 27", 30", 33",  
 36", \*39" or \*42" Width

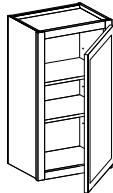

**Single Door**  
 36" Height  
 9", 12", 15", 18" or 21" Width

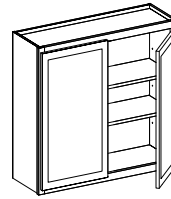

**Double Door**  
 36" Height  
 24", 27", 30", 33",  
 36", \*39" or \*42" Width

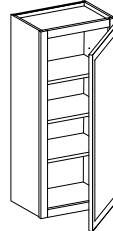

**Single Door**  
 42" Height  
 9", 12", 15", 18" or 21" Width

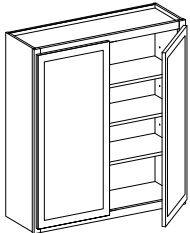

**Double Door**  
 42" Height  
 24", 27", 30", 33",  
 36", \*39" or \*42" Width

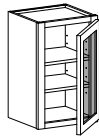

**Single & Double Glass Door**  
 Matching Finish Color Interior  
 30" Height  
 15", 18", 30" or 36" Width

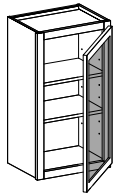

**Single & Double Glass Door**  
 Matching Finish Color Interior  
 36" Height  
 15", 18", 30" or 36" Width

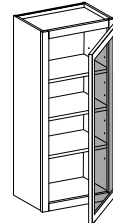

**Single & Double Glass Door**  
 Matching Finish Color Interior  
 42" Height  
 15", 18", 30" or 36" Width

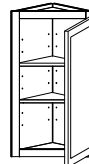

**Wall End Single Door**  
 30", 36" or 42" Height  
 12" Width

*Glass door wall cabinets only available in the Premier collection*

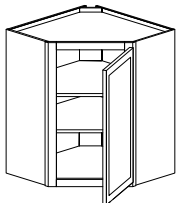

**Diagonal Corner**  
 30", 36" or 42" Height  
 12 or 15" Depth  
 24" and 27" Width

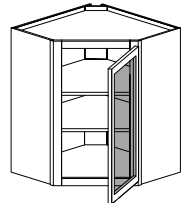

**Diagonal Corner Glass Door**  
 Matching Finish Color Interior  
 30", 36" or 42" Height  
 12 or 15" Depth  
 24" and 27" Width

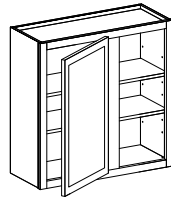

**Universal Blind Corner**  
 30", 36" or 42" Height  
 30"-33" Width

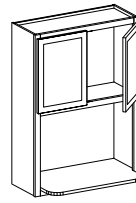

**Microwave Wall Cabinet**  
 Extended Shelf  
 36" Height  
 30" Width

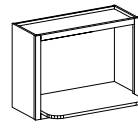

**Microwave Wall Cabinet**  
 Extended Shelf  
 18" Height  
 30" Width

*Glass door wall cabinets only available in the Premier collection*

## BASE CABINETS

\*39" and 42" widths will have a vertical center stile unless otherwise noted

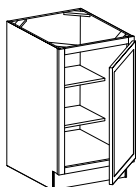

**Full Height Single Door**  
 9", 12", 15" or 18" Width

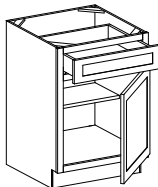

**Single Door and Drawer**  
 12", 15", 18" or 21" Width

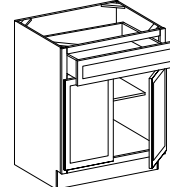

**Double Door and Single Drawer**  
 24", 27" or 30" Width

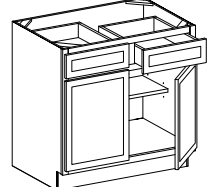

**Double Door and Double Drawer**  
 33", 36", \*39" or \*42" Width

# 2,100 Cabinet Options in Stock for Quick Shipment

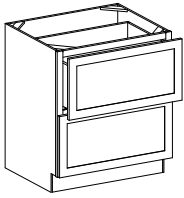

**Double Drawer**  
30" or 36" Width

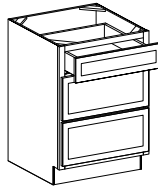

**Triple Drawer**  
12", 15", 18", 21", 24", 30"  
or 36" Width

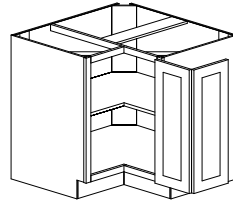

**Base Corner Cabinet**  
33" or 36" Width

(Lazy Susan inserts available)

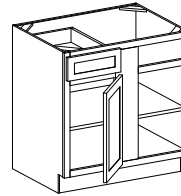

**Universal Blind  
Base Corner**  
39"-42", 42"-45" or  
\*45-48" Width

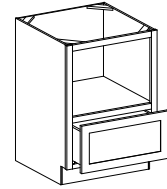

**Microwave Base  
Cabinet with Drawer**  
30" Width

## SINK BASE CABINETS

\*39" and 42" widths will have a vertical center stile unless otherwise noted

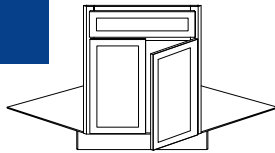

**Corner Sink Front  
Double Door**  
24" Depth  
(2-piece bottom panel)

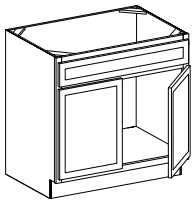

**Sink Base  
Double Door**  
30", 33", 36" or 39" Width

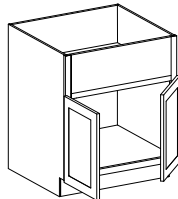

**Farmhouse Sink  
Base Double Door**  
36" or 39" Width  
(No center stile)

## TALL CABINETS

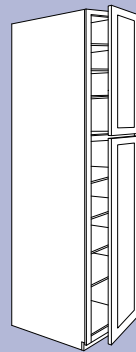

**Utility/Pantry  
Single Door**  
84", 90" (6 shelves),  
or 96" Height (7 shelves)  
18" Width

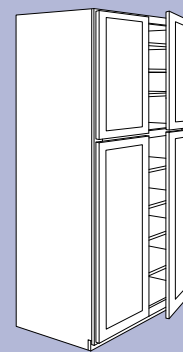

**Utility/Pantry  
Double Door**  
84", 90" (6 shelves),  
or 96" Height (7 shelves)  
24" or 30" Width

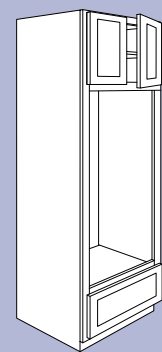

**Oven Double Door,  
Single Drawer**  
84", 90" or \*96" Height  
33" Width  
\*Single shelf in 96" only  
(Double Oven Overlay Panel available)

## VANITY CABINETS

21" deep, 34-1/2" high except where noted

\*42" widths will have a vertical center stile

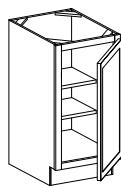

**Single Door**  
12" Width

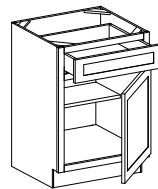

**Single Door  
and Drawer**  
12", 15" or 18" Width

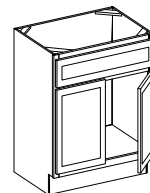

**Double Door**  
24", 27", 30", 33"  
or 36" Width

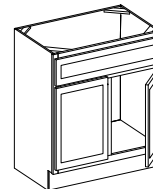

**Double Door  
Center Stile**  
42" Width

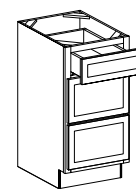

**Triple Drawer**  
12", 15", 18" and  
21" Width

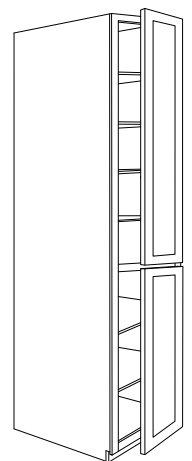

**Linen Single &  
Double Door**  
84" (6 shelves)  
Single - 15" and 18" Width  
Double - 24" Width

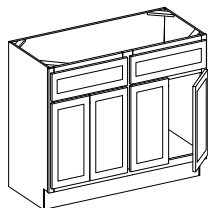

**Two Double Door**  
48" Width

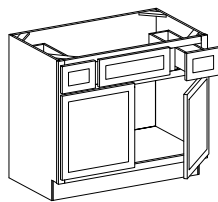

**Double Door and  
Double Drawer**  
36", 42" or 48" Width

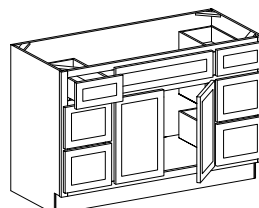

**Double Door and  
Six Drawer**  
60" Width

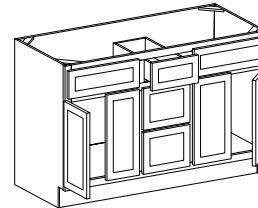

**Two Double Door and  
Triple Drawer**  
60" Width

# DESIGN TOOLS

NorthPoint Cabinetry products are available for ProKitchen and 2020 Design Software so that customers have access to the right tools to create amazing spaces.



[www.ProKitchenSoftware.com](http://www.ProKitchenSoftware.com)



[www.2020spaces.com](http://www.2020spaces.com)



Let us quote a full kitchen and **see the value!**



To learn more about the quality accessories we offer or other products we manufacture visit [www.NorthPointCabinetry.com](http://www.NorthPointCabinetry.com), call 1-800-463-0660 or scan the QR code with your smartphone or mobile device.